

**P7 Transfer Test**

**Paper 4**

Time allowed: 1 hour

Please complete the following information:

Name: \_\_\_\_\_

Class: \_\_\_\_\_

Teacher: \_\_\_\_\_

Date: \_\_\_\_\_

Mathematics		
Page	Marks	Score
7	(5)	
8	(6)	
9	(5)	
10	(5)	
11	(5)	
Total (26 Marks)		

English		
Page	Marks	Score
3	(2)	
4	(8)	
5	(2)	
6	(6)	
13	(2)	
14	(6)	
Total (26 Marks)		

## Egyptian Holidays

1 The region of Sharm El Sheikh is located on the eastern shore of the southern most tip of the Sinai Peninsula in Egypt. It overlooks the crystal clear waters of the Red Sea and is made up of a series of bays with outstanding coral reefs. The abundant variety of colourful sealife and the warm clear waters make this region a divers' heaven.

2 There is an excellent range of good quality hotels in the area and all offer easy access to the lively resort of Naama Bay which has shops, bazaars, restaurants and local entertainment.

3 Apart from superb diving, there are many other sporting activities on offer including golf, tennis and either horse or camel riding. There are trips into the desert on horse back or by camel as well as by jeep. Quad biking in the desert is also a popular pastime. The little town of Sharm El Sheikh is worth visiting for a taste of old Egypt with its spice shops and sugar cane juice stalls.

4 Sharm also makes a good base from which to explore the nearby mountains and desert, and with access to St Catherine's Monastery, the Coloured Canyon and a number of beautiful National Parks there is always something new and interesting to discover.

8. Which phrase of three words in the first paragraph indicates that the visibility in the sea is excellent?

crystal clear waters

9. Which phrase of three words in the article shows that Sharm El Sheikh is a great place for diving?

a diver's heaven

Do not write in this column

2 Marks



20. Jeremy's dad bought 10 packets of crisps and 8 bottles of juice

The crisps cost a total of £2.40.

How much did each bottle of juice cost if he had £4.80 change from a £10 note?

*so he spent £5.20 altogether*  

$$\begin{array}{r} 10.00 \\ - 4.80 \\ \hline 5.20 \end{array}$$
*on both crisps and drinks*

Tick  the correct box. 
$$\begin{array}{r} £3.20 \\ - 2.40 \text{ crisps} \\ \hline £2.80 \text{ juice} \end{array}$$

$$\begin{array}{r} 0.35 \\ 8 \overline{) 2.80} \end{array}$$

£0.55

£0.60

£0.35

21. Barney stood on a set of digital bathroom scales. The readout, in kilograms, is as follows.

$$\begin{array}{r} 45.07 \\ - 3.50 \\ \hline 41.57 \end{array}$$

What would it read if he lost 3.5 kilograms in weight? Write your answer in the box.

$$41.57$$

The grid below shows the position of some buildings in a small town.

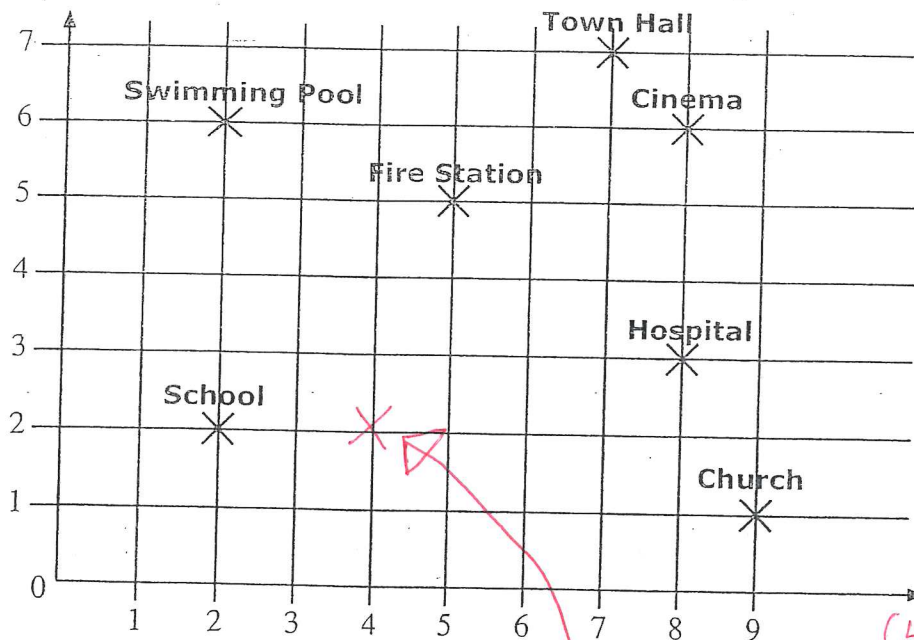

22. A new library is being constructed at (4, 2). Put an X on the grid to show the exact position of the new library.

*(4, 2)  
(across, up)*

23. What are the co-ordinates of the school?  $(2, 2)$

24. What are the co-ordinates of the hospital?  $(8, 3)$

Do not write in this column



## SPARROW WATCH

1 It may seem surprising, but the numbers of house sparrows in the United Kingdom are declining. Studies have shown that the house sparrow population has more than halved in the last 25 years. The Royal Society for the Protection of Birds are carrying out a survey to find out why this is happening and what can be done to reverse this decline.

There are many theories for this decline:

- 2 • the lack of food in the wider countryside due to more efficient farming methods
- the lack of nest sites in modern buildings offers sparrows fewer nesting opportunities
- the development of derelict land may have reduced food availability
- the increased use of pesticides in the countryside and gardens may reduce the numbers of insects which sparrows need to feed their young.

What can I do?

3 With your help, the RSPB aims to find out more about house sparrow numbers throughout the UK. The first step in any conservation action is to collect data. We need to know where house sparrows are doing well and where they are doing badly. Because house sparrows live near us, we asked you to count your local sparrows when they are most active. Of course, it is just as important to know if you don't have any sparrows too.

14. Look at the theories. Find a phrase of two words which means the same as 'an unused area'.

derelict land

15. What is the first step in conservation action?

collect data

Do not write in this column

✓

✓

16. The following statements are either true or false.

Tick  the correct box.

Sparrow numbers are increasing.

True

False

There is an increased use of pesticides.



All 4 = 2

Collecting data is the last step.



2 or 3 = 1

Sparrows feed insects to their young.



Do not write in this column

17. For which two reasons are the RSPB carrying out this survey? *paragraph 1*

Write your answers in the spaces below.

(1) to find out why the numbers of house sparrows are declining

both

(2) to see what can be done to reverse the decline

18. Which words in the story have a similar meaning to each of the following four words? Write your answers in the spaces provided.

information

data

cut in two

halved

All 4 = 2

effective

efficient

2 or 3 = 1

less

fewer

19. Write in the spaces below the two abbreviations used in the article.

R.S.P.B.

both

U.K.

29. Look carefully at each of the following shapes.

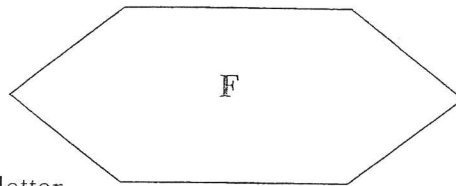
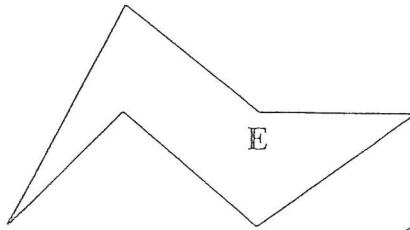
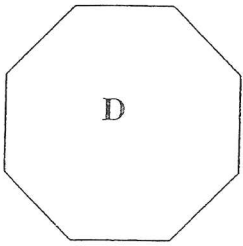
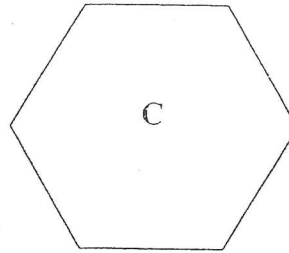
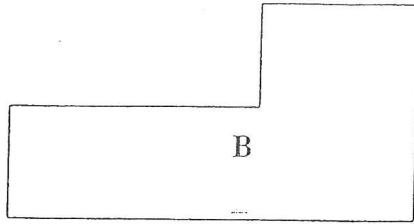
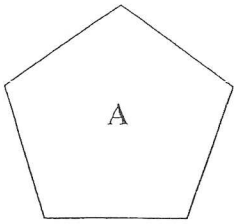

Complete the Carroll diagram by writing the letter of each shape in the correct place.

<p><i>All sides equal in length</i> <i>All angles equal</i> regular</p>	<p><i>6 straight sides</i> hexagonal</p>	not hexagonal
	C	A D
not regular	F B E	

*All 6 = 2 marks*  
*4 or 5 = 1.*

Maria put up 6 shelves in her kitchen. Each shelf was 157 cm long.

30. What was the total length of wood she used?

Give your answer in metres.

*1 metre = 100cm*  
*so 9 metres = 900cm*

9.42 m

$$\begin{array}{r} 157 \\ \times 6 \\ \hline 942 \text{ cm} \end{array}$$

31. Look at the following calculations.

Tick  the boxes next to the **two calculations** that give the answer 255.6

2.13 x 12

21.3 x 12

213 x 12

2.13 x 120

21.3 x 120

213 x 120

Do not write in this column

32. The manageress of a clothes shop decides to reduce the price of a skirt by 15% and increase the price of a jacket by 10%. The skirt is currently priced at £35.00 and the jacket costs £65.40.

What are the new prices for each of these items?

$£35.00 - 25\%$   
The skirt is now priced at: £ 26.25

$£65.40 + 10\%$   
The jacket is now priced at: £ 71.94

$$\begin{array}{r} 0.875 \\ + 135.00 \\ \hline 26.25 \end{array}$$

$$\begin{array}{r} 65.40 \\ + 6.54 \\ \hline 71.94 \end{array}$$

Beechwood School are giving a concert.

Each of the seven classes sells tickets for 5 days.

The table below shows the number of concert tickets sold by each class.

	Mon	Tues	Wed	Thurs	Fri
Class 1	8	12	10	9	5
Class 2	8	10	9	8	6
Class 3	7	11	9	7	10
Class 4	9	9	9	11	12
Class 5	10	8	3	12	7
Class 6	6	5	12	2	5

33. What was the total number of tickets sold by Class 4?

$$9 + 9 + 9 + 11 + 12$$

50

34. What is the mean (average) number of tickets sold by Class 6?

$$6 + 5 + 12 + 2 + 5 = 30$$

$$30 \div 5 \text{ days} = 6$$

6

35. John is now half Paul's age.

In eight years time John will be 22 years old.

*John is now 14. Paul is now 28 (14 years older)*

How old will Paul be when John is 22 years old?

$$28 + 8$$

36

Do not write in this column

✓

✓

## The First Moon Landing

1 On July 20, 1969, Commander Neil Armstrong became the first man on the moon. He said the historic words, "One small step for man, one giant leap for mankind."

2 A camera in the Lunar Module provided live television coverage as Neil Armstrong climbed down the ladder to the surface of the moon.

3 The Lunar Module "Eagle" consisted of two parts: the descent stage and the ascent stage. The descent stage provided the engine used to land on the moon. It had four legs, a storage area for experimental gear, and a ladder for the crew to climb down to the moon's surface. The descent stage also served as the launch platform for the ascent module when it came time to leave.

4 To walk on the moon's surface, the astronauts needed to wear a space suit with a back-mounted, portable life support system. This controlled the oxygen, temperature and pressure inside the suit.

5 On the surface, the astronauts had to get used to the reduced gravity. They could jump very high compared to on Earth.

6 The crew spent a total of two and a half hours on the moon's surface. While on the moon's surface, they performed a variety of scientific experiments and collected soil and rock samples to return to Earth. An American flag was planted on the moon's surface as a reminder of this magnificent accomplishment.

43. Which word is used to describe ground level in the last paragraph?

surface

44. What memento was left behind by the astronauts?

(an American) flag

Do not write in this column

✓

✓

45. Which phrase of two words in the story means the same as descended?

climbed down

46. Name the two parts of the Lunar Module 'Eagle'.

descent stage

ascent stage

both

47. Which gas is mentioned in the story?

oxygen

48. Find a word or words in the article which are the same as the following words.

Write your answers in the spaces provided:

tests

experiments

can be carried

portable

achievement

accomplishment

Do not write in this column

✓

✓

✓

✓

✓

$$08:55 + 4 \text{ hrs} = 12:55 + 5 \text{ mins} = 13:00 + 7 \text{ mins} = 13:07$$

36. Sammy started a hike at 0855.

He finished the hike in four hours and 12 minutes later.

At what time did he finish the hike?

13:07  
 or 1:07 pm  
 not 1:07

Siobhan has a game that can only be played by one player.

She plays the game 7 times.

*difference between highest + lowest scores*  
 The range of her scores is 8.

Her mean (average score) is 13.

Her lowest score was 6.

37. What was her highest score?

*lowest = 6 range = 8  
 so 6 + 8*

14

38. What was her total score?

*average = 13 x 7 games*

91

Sheila ran around the perimeter of her playground.

This is a diagram of her playground.

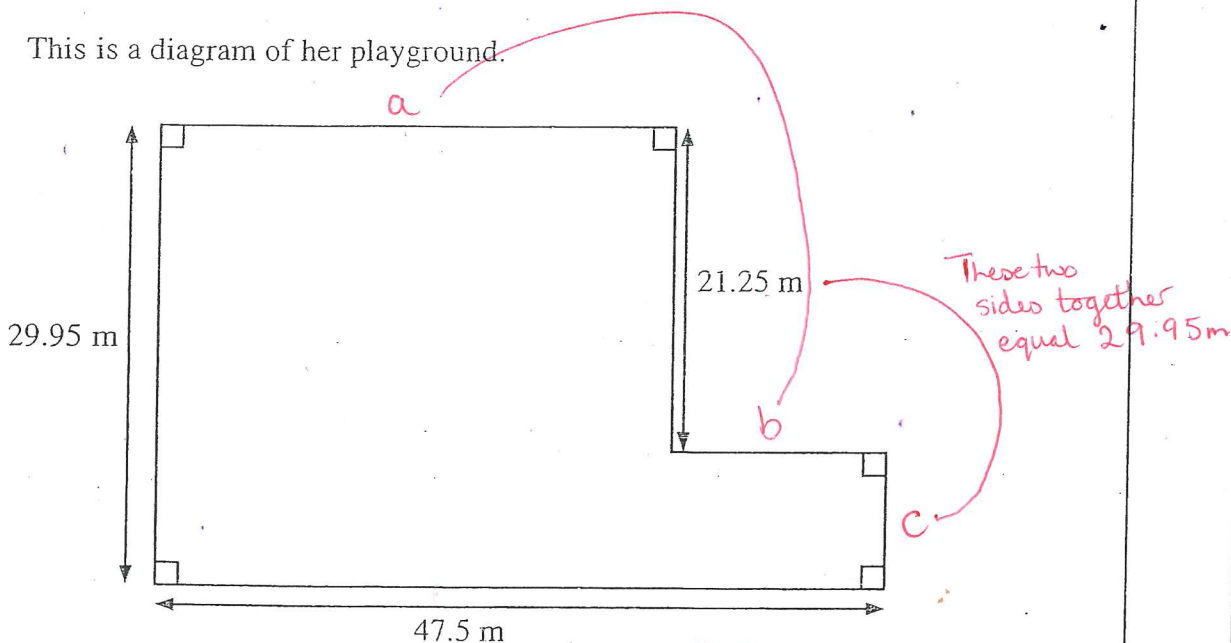

39. What is the difference between the length and the breadth of the playground in metres?

$$\begin{array}{r} 47.50 \\ - 29.95 \\ \hline 17.55 \end{array} \text{ metres}$$

40. Use the diagram to work out how far she ran in metres.

*line a + line b = 47.5m*

$$154.9 \text{ metres}$$

Do not write in this column

✓

✓

✓